

# LES SUPERFICIES : $MM^2$ - $CM^2$ - $DM^2$

1) Place " $mm^2$ " et " $dm^2$ "

				$cm^2$			

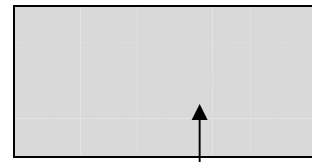

Estime	Mesure et transforme		
.....	..... $mm^2$	..... $cm^2$	..... $dm^2$

2) Estime, mesure les surfaces ci-dessous.

Transforme ensuite les unités de mesure.

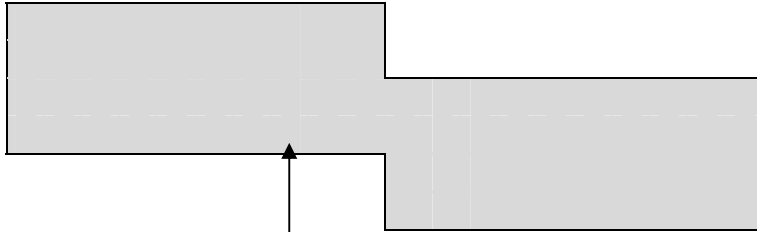

Estime	Mesure et transforme		
.....	..... $mm^2$	..... $cm^2$	..... $dm^2$

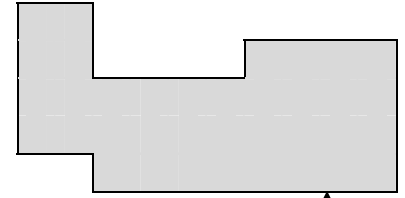

Estime	Mesure et transforme		
.....	..... $mm^2$	..... $cm^2$	..... $dm^2$

Estime	Mesure et transforme		
.....	..... $mm^2$	..... $cm^2$	..... $dm^2$

Estime	Mesure et transforme		
.....	..... $mm^2$	..... $cm^2$	..... $dm^2$

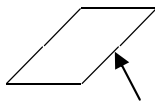
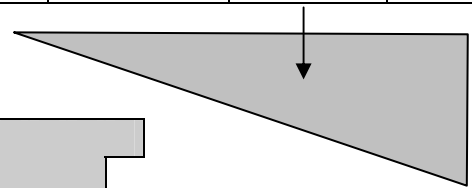

Estime	Mesure et transforme		
.....	..... $mm^2$	..... $cm^2$	..... $dm^2$

Estime	Mesure et transforme		
.....	..... $mm^2$	..... $cm^2$	..... $dm^2$

Estime	Mesure et transforme		
.....	..... $mm^2$	..... $cm^2$	..... $dm^2$

Estime	Mesure et transforme		
.....	..... $mm^2$	..... $cm^2$	..... $dm^2$

